

IMMERSION THERMOCOUPLES

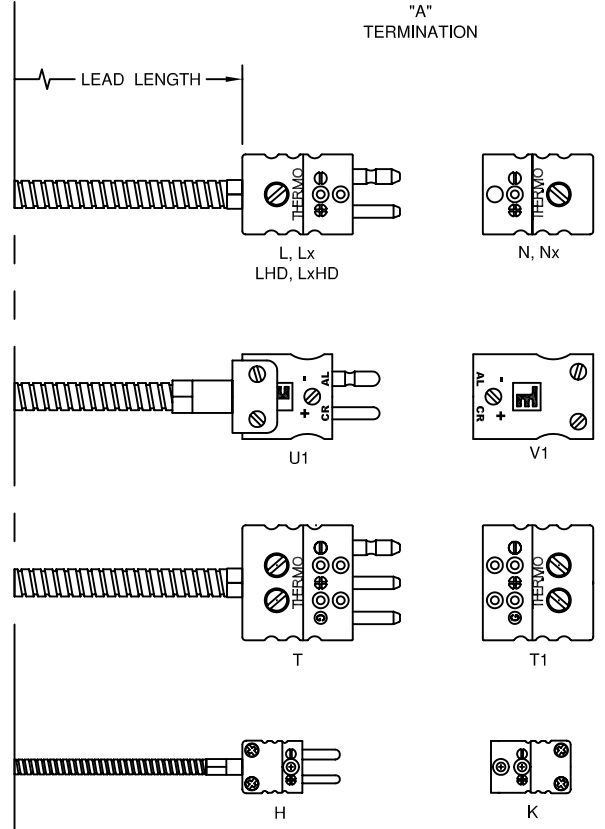
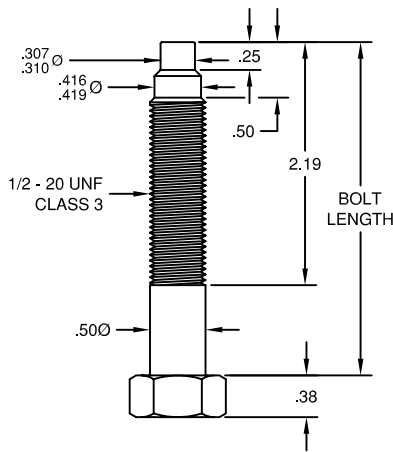
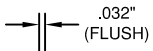
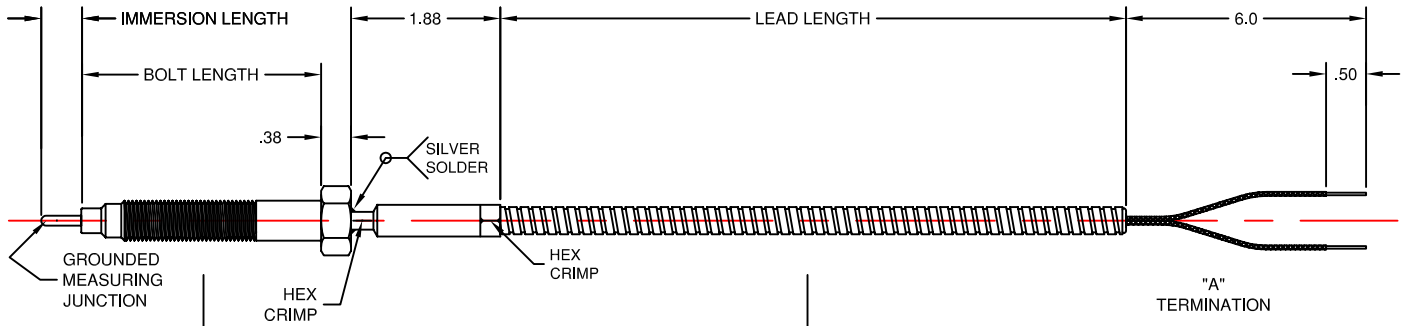

SPECIFICATIONS

- Thermocouple
- Sheath Diameter: 1/8"
- Sheath Material: 300 Series Stn. Stl.
- Measuring Junction: Grounded
- Bolt Material: Carbon Steel
- Lead Wire:
- Conductor Size: 20 Gauge Stranded
- Conductor Material: T/C Alloy
- Insulation: Fiberglass
- Jacket: Flexible Armor, 300 Series Stn. Stl.

ORDERING CODE:

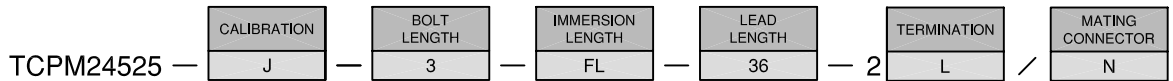

Notes:

- (1) Meets or exceeds Special Initial Calibration Tolerances per ANSI MC96.1-1982 and ASTM E230-1993
- (2) Bolt and Sheath available in other materials (Hastelloy C276, 300 series Stn. Stl.).
- (3) Omit mating connector if not ordered. Mating connector can be attached to the leads.
- (4) Available with spade lugs, replace "A" with "LG".
- (5) For an item that does not fall within the catalog description an (SP) can be added to the ordering code as part of a custom construction.

EXAMPLE: TCPM24525-J-3-FL-36-2L/N

CODE	LEAD LENGTH (IN INCHES)
36	36

CODE	IMMERSION LENGTH
FL	FLUSH
1/2	1/2"
1	1"

CODE	BOLT LENGTH
3	3"
6	6"
9	9"
12	12"

CODE		CALIBRATION
STD.	SPECIAL (NOTE 1)	
J	JJ	IRON(+) vs CONSTANTAN(-)
K	KK	CHROMEL(+) vs ALUMEL(-)
T	TT	COPPER(+) vs CONSTANTAN(-)
E	EE	CHROMEL(+) vs CONSTANTAN(-)
N	NN	NICROSIL(+) vs NISIL(-)

CODE		TERMINATION	MATING CONN. (NOTE 3)
			CODE TEMPERATURE LIMIT
A		BARE ENDS (NOTE 4)	
L		STANDARD SIZE PLUG	N 390°F(200°C)
LHD		STANDARD SIZE SOLID PIN PLUG	N 390°F(200°C)
Lx		EXTENDED LIMITS PLUG	Nx 660°F(320°C)
LxHD		EXTENDED LIMITS SOLID PIN PLUG	Nx 660°F(320°C)
U1		IMPACT RESISTANT PHENOLIC PLUG	V1 300°F(150°C)
T		THREE PIN PLUG	T1 390°F(200°C)
H		MINIATURE PLUG	K 390°F(200°C)



TEMPERATURE MEASUREMENT DESIGNER'S GUIDE
WWW.THERMO-ELECTRIC-DIRECT.COM

SECTION IMTC

PLASTIC MELT BOLT THERMOCOUPLES with ARMORED LEAD WIRE SINGLE CONSTRUCTION

The information contained hereon shall be considered the sole property of Thermo Electric Company, Inc. The recipient thereof agrees not to disclose or reproduce said information to parties outside the recipient's organization without the written permission of Thermo Electric.

Doc. No.: TE-CO010109-IMTC-090